

ZCY Buildings Group 28/9/20

Community retrofit schemes

(EcoHolmes are both retrofit and newbuild!)

Matthew Tulley



EcoHolmes
Community Land Trust

AFFORDABLE LOW ENERGY HOUSING
FOR THE HOLME VALLEY

Background

- EcoHolmes started Nov 2019
- CLT established; owned and run by the community
- 9 on management board
- 56 members (at 31/8/20), join if you want for £1
- 12 zoom consultations involving 68 people
- Design specification evolving

www.ecoholmes.org.uk

info@ecoholmes.org.uk

m.tulley@solidcstore.org Matthew Tulley



EcoHolmes
Community Land Trust

AFFORDABLE LOW ENERGY HOUSING
FOR THE HOLME VALLEY

Design principles – block layout

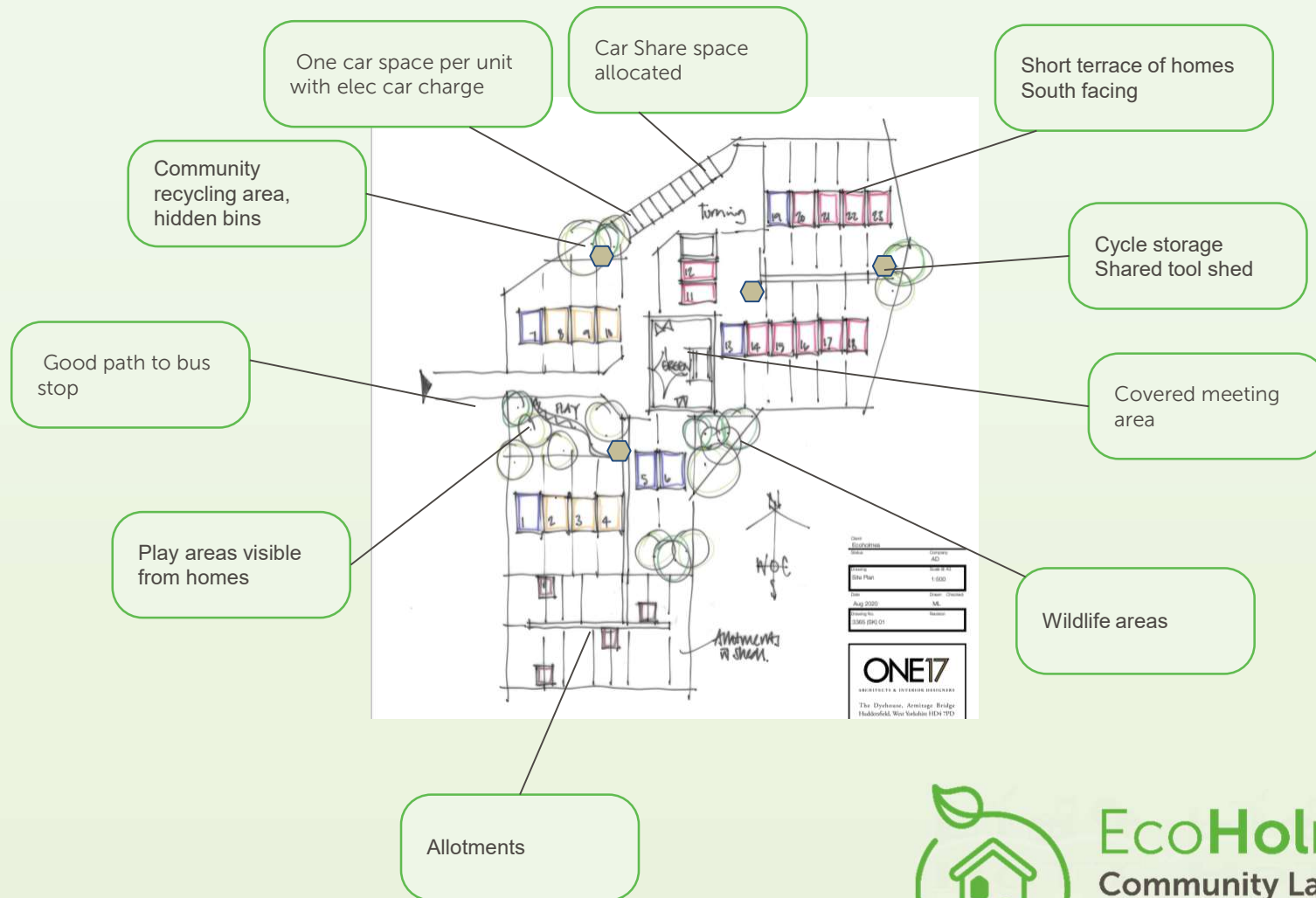

EcoHolmes
Community Land Trust

AFFORDABLE LOW ENERGY HOUSING
FOR THE HOLME VALLEY

Design principles – House layout

Ref: Plymouth Community Homes
Passivhaus development
Completed August 2019.

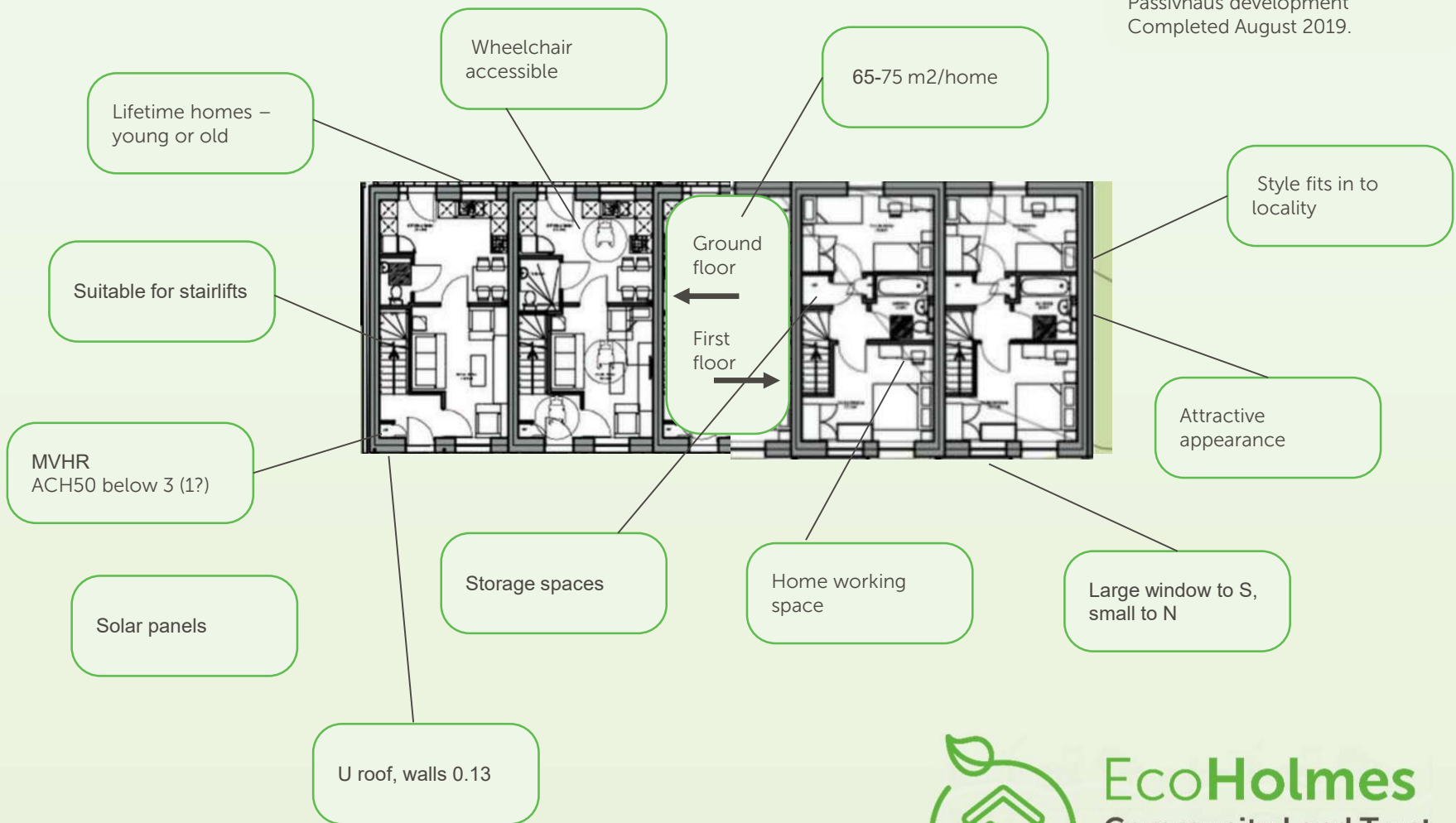

EcoHolmes
Community Land Trust

AFFORDABLE LOW ENERGY HOUSING
FOR THE HOLME VALLEY

Next steps

- Progress with shortlisted sites
 - Detail design
 - Develop planning application
-
- PLEASE TALK TO US
 - Consider joining the CLT

www.ecoholmes.org.uk

info@ecoholmes.org.uk

m.tulley@solidcstore.org Matthew Tulley



EcoHolmes
Community Land Trust

AFFORDABLE LOW ENERGY HOUSING
FOR THE HOLME VALLEY